



Apt 208 The Arthouse, 43 George Street, Manchester, M1 4AB

This period conversion one bedroom corner apartment is located in the heart of China Town and benefits from high ceilings, timber joists and exposed brickwork. The long entrance hall leads to all rooms, the corner living/kitchen has sash windows and exposed brickwork, double bedroom and modernised shower room with vanity sink and walk in shower. No Chain.

Offers In Excess Of £170,000

Viewing arrangements

Viewing strictly by appointment through the agent
245 Deansgate, Manchester, M3 4EN 0161 833 9499 opt 3

Entrance Hall

Long hallway with wooden flooring, electric heater and exposed brickwork

Living/Kitchen

18'7" x 11'6"

High ceilings, corner aspect with sash windows, exposed brickwork and wooden flooring. Electric heater. The kitchen has circular sink unit, oven, hob and under unit lighting, dishwasher and fridge

Bedroom

9'11" x 8'2"

Large sash window, exposed brickwork, wooden laminate flooring. High level cupboard housing hot water system

Shower Room

7'7" x 4'8"

Modernised shower room with vanity sink unit, w.c and walk in shower. Mirrored wall and heated towel rail.

Additional Information

Service charge £2444.90

Lease 125 Years from 2003

Ground Rent £200 pa

Building Managed by IPM

Agents Notes

To be able to purchase a property in the United Kingdom all agents have a legal requirement to conduct Identity checks on all customers involved in the transaction to fulfil their obligations under Anti Money Laundering regulations. We outsource this check to a third party and a charge will apply. Ask the branch for further details.

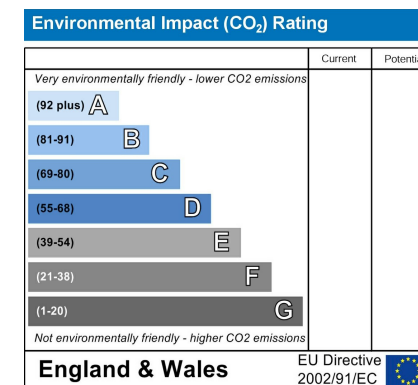
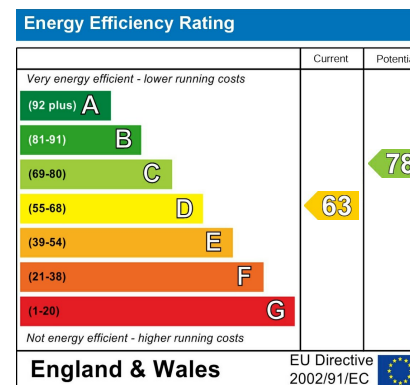



GROUND FLOOR

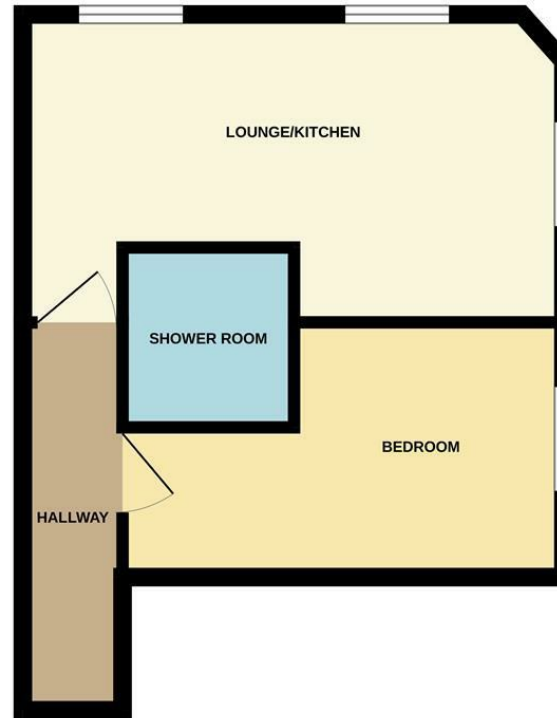

Measurements are approximate. Not to scale. Illustrative purposes only.
Made with Metropix ©2025



These particulars are believed to be accurate but they are not guaranteed and do not form a contract. Neither Jordan Fishwick nor the vendor or lessor accept any responsibility in respect of these particulars, which are not intended to be statements or representations of fact and any intending purchaser or lessee must satisfy himself by inspection or otherwise as to the correctness of each of the statements contained in these particulars. Any floorplans on this brochure are for illustrative purposes only and are not necessarily to scale.

Offices at: Chorlton, Didsbury, Disley, Hale, Glossop, Macclesfield, Manchester Deansgate, Manchester Whitworth Street, New Mills, Sale, Wilmslow and Withington

245 Deansgate, Manchester, M3 4EN

0161 833 9499 opt 3

manchester@jordanfishwick.co.uk

www.jordanfishwick.co.uk

